



PENTA

Sunset New Collection 2023

Sunset

Debiasi & Sandri

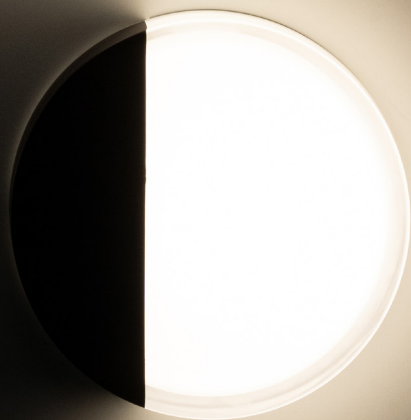
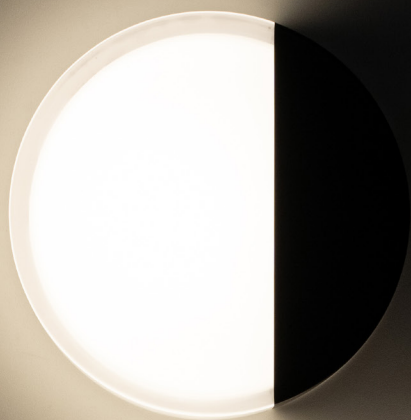



Sunset

Minimalism and poetry chase each other and intertwine in the Sunset lamp collection: the line of the horizon that the sun drops into at sunset defines this lighting element with a clean stroke that seems to suggest the boundary between light and shadow. Made in two sizes and based on a cylindrical shape, the ceiling light hides the lamp's technical components behind the back-painted glass. The aesthetical element that suggests the name of the object becomes functional as it reveals the design contents of the project.

Minimalismo e poesia si rincorrono e si intrecciano nella collezione di lampade Sunset: la linea dell'orizzonte in cui si tuffa il sole al tramonto disegna l'oggetto luminoso con un tratto netto che sembra suggerire il confine tra luce e ombra. Realizzata in due dimensioni a partire da una forma cilindrica, la plafoniera in vetro nasconde dietro alla lunetta verniciata la componente tecnica della lampada. L'elemento estetico che suggerisce il nome dell'oggetto diventa funzionale rivelando i contenuti di design del progetto.

Key points

Total glass body

Full brightness
LED board (repleaceable)

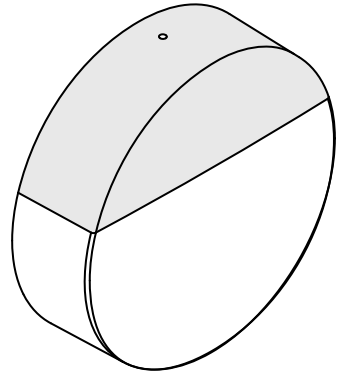
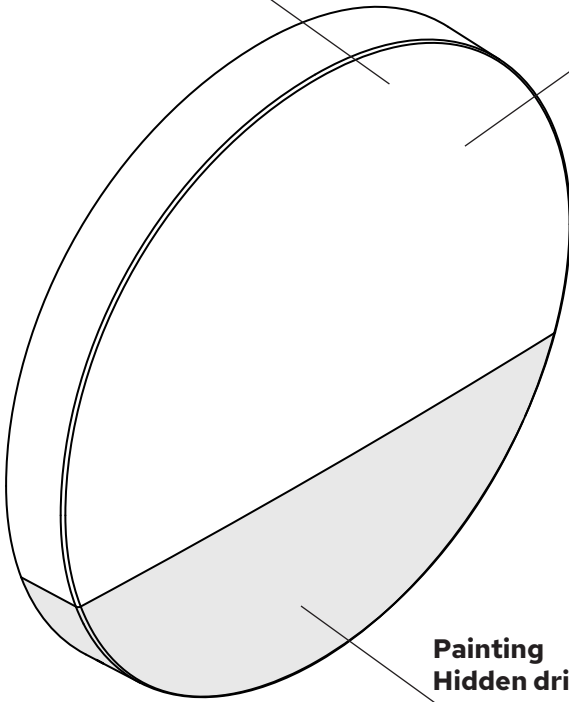

Painting
Hidden driver

Ø 42 cm

Ø 20 cm

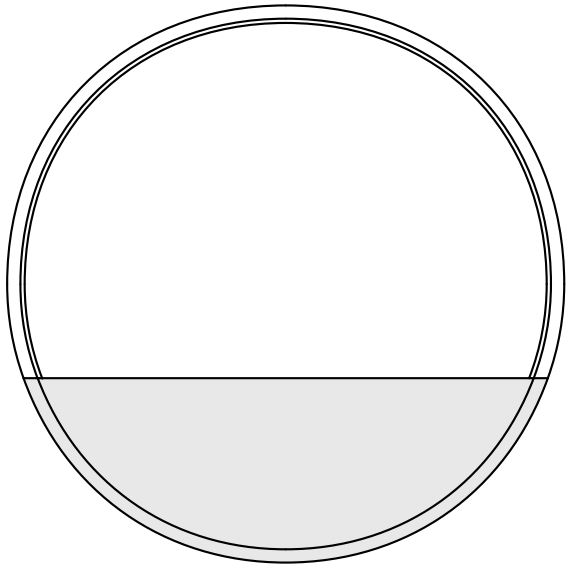
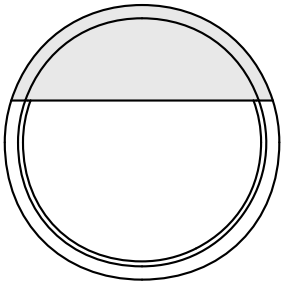

Different compositions

Sunset

2303-41 MEDIUM

12.5W - 3000K

12.5W - 2700K

Dimmable phase cut

IP20

LED



2303-42 LARGE

25-30W - 3000K

25-30W - 2700K

Dimmable phase cut

IP20

LED



2303-41

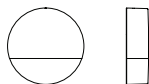

Ø20 x W6.3

2303-42

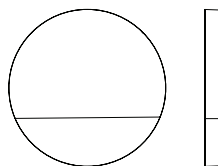

Ø42 x W5

1:20

Finishes / Finiture

Glass / Vetro



Satin glass
Vetro satinato

+



Painted glass gold
Vetro verniciato oro



Satin glass
Vetro satinato

+



Painted glass black
Vetro verniciato nero



Satin glass
Vetro satinato

+



Painted glass titanium
Vetro verniciato titanio

Debiasi & Sandri

Daniel Debiasi and Federico Sandri found their own design studio in 2010. Their collaboration evolves along a continuous dialogue encouraged by spatial, cultural and behavioural observations.

Multiple experiments with different materials and processes, and the relationship between manufacture and craftsmanship form the basis for a much broader thinking where objects are always considered as part of a bigger picture.

Daniel Debiasi e Federico Sandri fondano il loro studio nel 2010, attività frutto delle loro competenze, affinità e complementarietà progettuali. La loro collaborazione è fondata su un dialogo incoraggiato dall'osservazione di spazi, comportamenti umani ed aspetti culturali.

La sperimentazione su materiali, forme e processi, ed il legame tra industria e "saper fare" artigianale sono alla base del loro pensiero "allargato" che vede i prodotti come parti di un sistema ben più ampio.